

Instructions for Use

- ★ Read the accompanying instructions carefully before using and use as directed.
- ★ Product may cause an allergic reaction. In rare cases, it may lead to severe reactions.
- ★ Perform a skin allergy test before the application of the product.

Caution for Use

1. DO NOT USE:

- 1 If you have ever experienced an allergic reaction to this or any other hair colorant product,
- 2 If you have ever experienced hives, itchiness, rash, or redness, or felt unwell with symptoms such as breathing difficulties or dizziness, either during or just after coloring your hair,
- 3 If you have ever had an abnormal reaction to the skin allergy test,
- 4 If you have sensitive scalp or skin (e.g. during or when recovering from illness; during menstruation or pregnancy).
- 5 If you have an inflammation, cut or skin problem on the head, face or neck,
- 6 If you have ever suffered from kidney diseases, blood disorders or other such medical conditions,
- 7 If you have symptoms of illness (slight fever, fatigue, palpitations, shortness of breath, tendency toward bruising or bleeding, have heavy or prolonged menstruation or other bleeding).

2. Before usage:

- 1 Before each use of this product, perform a skin allergy test 2 days (48 hours) in advance, following the directions on the right.

The skin allergy test indicates whether you are prone to allergic reactions from hair colorant ingredients. Check the test site twice-once, 30 minutes after applying the test mixture and again after 48 hours. Even if you have colored your hair many times before with no reaction, changes in body conditions may cause a reaction to occur. So, perform this test each time before use without fail.

- 2 This product is only intended for hair on the head. Do not use it anywhere else.
- 3 Do not use on eyelashes or eyebrows as cream may drip into your eyes.
- 4 Do not use immediately after shaving as skin may have small cuts and is prone to irritation.
- 5 If you have just permed your hair, allow at least a one week interval before using this product as it may result in hair damage or hair discoloration. Similarly, after hair coloring, at least one week interval should be given before perming to avoid hair damage or hair discoloration.

3. When coloring your hair:

- 1 Use cream mixture immediately after mixing.
- 2 Use in a well-ventilated area.
- 3 Wear the gloves provided.
- 4 Do not wet your hair before product application nor bathe during product application. Perspiration or water droplets may cause cream to get into your eyes.
- 5 Avoid getting the cream onto the face or neck. If it happens, wash off immediately with water.
- 6 Avoid letting the cream and the rinsing water come in contact with your eyes as it may cause severe pain. In some cases, eye damage can occur (e.g. inflammation of the cornea). DO NOT RUB your eyes if cream or its rinsing water comes in contact with them. Rinse eyes immediately with cold or lukewarm water for at least 15 minutes and seek medical attention immediately.
- 7 During application, if you experience any skin abnormalities such as rash, redness, inflammation, itching, strong irritation, or if symptoms such as hives, breathing difficulties or dizziness appear, rinse the cream off thoroughly and seek medical attention immediately.
- 8 If you experience any abnormalities after application, seek prompt medical attention.

4. Handling Advisory

- 1 Wash away the residue of the mixed cream because it is no longer effective.

5. Storage Advisory

- 1 Keep out of reach of children. Product is hazardous if ingested.
- 2 Store away from high temperatures or direct sunlight.

*Do not place product in any place where temperatures rise above 40°C.

*Do not use if bottle is broken.

*Do not place product near flames or throw into a fire.

*Empty the bottle before discarding. The nozzle and cap are made of plastic, while aluminum is used for the bottle.

*Any cream dispensed from bottle should be discarded immediately by washing, as it cannot be preserved for next use.

*Do not apply this product on children and infants.

*Carefully store this product in a safe place and keep out of reach of patients with dementia to prevent their accidental ingestion.

*Carefully check the skin for any abnormality during its use. Stop use and consult a dermatologist whenever the following symptoms are noticed: skin irritation, reddening, swelling, itching, stimulation, discoloration (vitiligo, etc.), darkening and similar abnormalities in response to exposure to direct sunlight. Continued use of this product may aggravate symptoms.

Caution! DO NOT USE If you have ever experienced an allergic reaction to a hair colorant product or if you obtained abnormal results from the skin allergy test.

For inquiries about this product:

(Monday - Friday, 8:30am - 5:30pm)

Malaysia, call: 1800 88 4588

Alternatively, visit <http://web.kao.com/my/lieise>

Singapore, call: 6396 0400

Alternatively, visit <http://web.kao.com/sg/lieise>

Skin Allergy Test Procedure

The Skin Allergy Test indicates whether you are prone to having an allergic reaction to the product. Even if you may have colored your hair many times before without experiencing any reaction, changes in body conditions may cause a sudden reaction to occur. So perform the test, **without fail each time, 48 hours before use.**

1 Have the following items ready.

Items included in the box

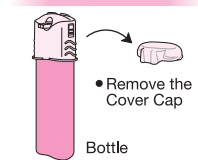

- Remove the Cover Cap

Bottle

Items not included in the box

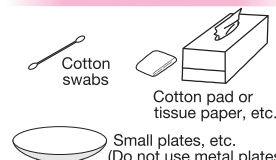

Cotton swabs

Cotton pad or tissue paper, etc.

Small plates, etc. (Do not use metal plates!)

2 Prepare the mixture.

1. Press the push lever at the top of the bottle hard, and put the cream on a small plate.



The cream can also be put in the protection cap.



Important Press the lever hard to push out the cream. Place a finger on the center of dimple of the push lever, and press hard until it stops. Check that both Cream 1 (Yellow) and Cream (2) are present on the plate / protection cap.

2. Use a cotton swab to mix them.



3 Apply mixture onto inner side of arm and leave for 48 hours.

- When the test mixture is ready, use the tip of the cotton swab to apply a thin round patch about the size of a \$1 coin on the inner side of your arm and let it dry naturally.
- It is important to leave the spot on for 48 hours.



★ Wash the nozzle immediately after application of cream on test spot is completed. Check right opposite of this instruction sheet for instructions on washing the nozzle.

★ The color of the part of your skin which you have applied the mixture on to may turn brown or other colors, but after the patch test this will disappear after a few days of normal bathing.

★ Be careful not to allow the test mixture spot to come into contact with your clothing before it dries up completely.

★ If the spot does not dry up within 30 minutes after application, gently blot the excess with a tissue.

★ To ensure that the result is accurate please do not moisten, scratch the test area or place any seals over it for 48 hours. It is advisable not to bathe or shower during the test. If you must bathe, make sure you do not get the spot wet.

4 Observe test area twice.

- 1) 30 minutes after application
- 2) 48 hours after application

★ If rash, redness, itchiness, blistering, irritation or other skin abnormality occurs, do not rub with your hands. Wash off test mixture immediately and DO NOT use the product.

★ If any of the above said reactions are noticed during test period, even if it is before the end of 48 hours, STOP TEST immediately. Wash mixture off and DO NOT use the product.

5 If there is no abnormal reaction after 48 hours, proceed to use the product.

If the Skin Allergy Test results in any abnormalities, please contact our product inquiry hotline.

An allergic reaction to the product consists of **itchiness, swelling, redness or rash** found mostly on areas like the scalp, hairline, forehead, face or neck. In some instances, there may only be **itchiness**. In the presence of such symptoms, no matter how mild or unnoticed, if usage is proceeded or repeated, you may run the risk of a severe, sudden allergic reaction (hives all over the body, breathing difficulties, etc.) It should be noted that if ANY of the said symptoms (even if it is only **itchiness** that is experienced currently or before, regardless of its severity) is experienced, **DO NOT USE** this product.

Preparation Before Application

Getting your hair ready

- Shampoo the day before you color your hair. If your hair has large amounts of hair styling agents, products such as temporary hair color (e.g. color foam or hair mascara) or metallic powder on it, rinse thoroughly and take care not to damage your scalp.
- If you wash your hair on the day you plan to color it, dry your hair thoroughly before application to avoid dripping of colorant and weakening of its effect.
- Allow at least a one week interval between perming and coloring of hair.

★ Comb your hair before coloring to remove any tangles.

1 Check the items you need.

Items included in the box

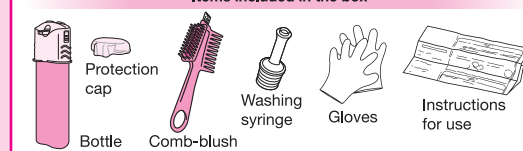

Protection cap

Bottle

Comb-blush

Washing syringe

Gloves

Instructions for use

Items not included in the box

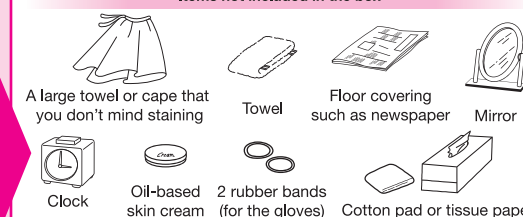

A large towel or cape that you don't mind staining

Towel

Floor covering such as newspaper

Mirror

Clock

Oil-based skin cream

2 rubber bands (for the gloves)

Cotton pad or tissue paper

2 Get yourself ready.

- Change into clothing you do not mind staining and wrap a towel around your neck.
- To easily remove any mixture that comes into contact with skin, apply a thin layer of oil-based skin cream to your hairline, ears, forehead and neckline etc. Ensure that oil-based skin cream does not get onto the hair, as it may weaken the coloring effect.
- ★ The cream may come in contact with the skin. In this case, immediately wipe it off with a wet cotton or tissue.
- Always wear gloves and place rubber bands around the wrists to avoid a bad fit.



- Keep the product at room temperature (between 20 and 30°C) for about one hour before mixing the solutions. If the solution is too cold or too warm, it may not be dispensed easily.
- Coloring result and ease of dispensing cream is affected by temperatures. Therefore, use this product under room temperature (between 20 and 30°C) conditions.

- Remove glasses, contact lenses, earrings, necklaces, rings and other jewelry before use.
- To avoid staining the floor with the foam mixture, spread a newspaper or other cover on the floor before use (colorant cannot be removed).
- Avoid taking a bath during application.
- Do not use metal combs or hairpins.

★ Be careful not to let product mixture come in contact with clothing, floors, carpets or walls as it will cause permanent stains.

HOW TO USE

Use one bottle for coloring whole short-length hair.

1 Dispense cream onto the brush part of the comb-brush.

Caution ! Do not dispense an excessive amount of cream on the brush part to prevent dripping.

Make a hole by cutting along the perforation on the reverse side of the package. This will prevent the bottle from toppling during use.

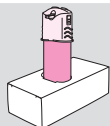

Check that both locks are appropriately set. Wear the gloves and dispense the cream on the brush part.

★ Remove the protection cap before use.

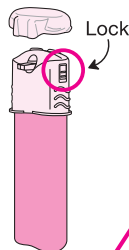

Move the bottle along the brush and dispense Cream 1 (yellow) and 2 (white) parallel to the brush.

(One bottle contains enough amount of cream to repeat this process about 15 times)

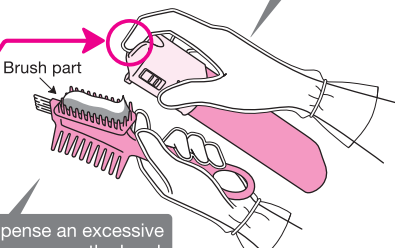

Do not dispense an excessive amount of cream on the brush to prevent dripping.

Important Press the button down firmly.

Place a finger on the center of dimple of the push button, and **press down until it stops**.



If not hard pressed or not on the center of dimple, Cream 1 and Cream 2 will not come out equally, which may affect the effect of coloring.

Pay attention to the directions for the brushing part and the bottle.

Dispense the creams so that Cream 1 and Cream 2 are parallel to the brush. In case the creams are applied over the side of the brush, they will not mix thoroughly over the hair and the expected coloring result will not be achieved.

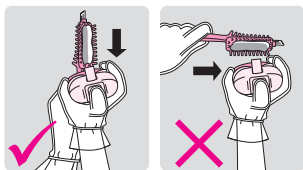

- ★ The hair will be colored only when the two creams are mixed. Depending on how the product was used, there may only be one cream remaining in bottle. In this case, please dismantle the push lever and reinstall it again. Then press hard the push lever. If there is still only one cream remaining in the bottle, stop using the product.
- ★ Small amounts of black or brown colored cream might appear in the beginning or end of use, but it does not affect hair coloring result.
- ★ Hair color after treatment appears different from the initial colors of the creams and may turn dark purple or brown. This change of color is normal and does not affect the coloring result.

2 Apply the cream to the dry hair.

Caution



- Do not apply the creams to the hair directly from the bottle.
- Apply carefully so that creams will not splatter.
- Take care so that the creams do not get into the eyes.
- Take care so that the comb does not hurt the scalp.
- The cream may come in contact with the skin. In this case, immediately wipe it off with a wet tissue.

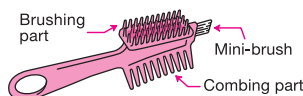

How to part the hair

Run through the tip of the comb from the front to top.



● How to Cover Visible Grays

1 Apply a large amount of the creams to the roots of gray hairs with the brush part, and allow cream to set.

Parting

Apply a large amount of creams to the roots, and spread to the part you are concerned about.



Hairline

Place the brush part parallel to the hairline and spread towards back of head.



Small areas of concern

Use the mini-brush to cover hard-to-reach areas with cream.



Application time:
within 20 minutes

2 Use the comb part to spread cream evenly over the entire head. Leave on for about 15 minutes.

★ It is recommended to leave the cream on for 5-10 minutes longer for thick and coarse hair.

Leave on time:
about 15 minutes

✎ Tips to color small areas effectively

Ensure that the area is completely covered with cream.

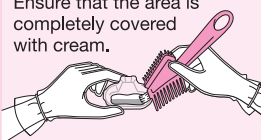

Dispense creams onto protection cap and **mix** with the mini-brush. Then, apply the mixture over the area with the mini-brush.

- ★ Press the lever until it stops, and confirm that both Cream 1 and Cream 2 are dispensed.
- ★ Do not dispense the creams directly on the mini-brush.

● How to color the entire head *Read the above procedures thoroughly.

1 Apply the cream to the front part of your hair with the brush part.

★ Part your hair to areas where gray hairs are more visible, and apply more cream to these areas.

2 Apply the cream over the back half of the hair.

★ Apply the cream mixture from the roots and spread it towards the nape. Allow the cream to set.

3 Use the combing part to spread the cream toward the tips of the hairs while combing. Leave on 15min.

★ For touch-up, allow cream to set for 10 minutes before combing from root to tip. Then, leave on for additional 5 minutes.

Application time:
upto 20 minutes

Leave on time:
about 15 minutes

3 Rinse your hair thoroughly, then finish with shampooing.

Shampoo your hair thoroughly twice.

Caution ! Ensure that rinsing water does not come into contact with eyes.

Remaining cream in bottle can be used for next coloring session.

★ Always wash the nozzle to prevent it from being clogged with the cream.

How to wash the nozzle

1 Detach the nozzle.

Pull the nozzle upward while pressing the locks on both sides. In this manner, remove the nozzle from the bottle.

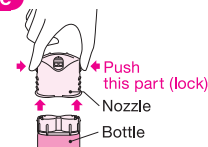

2 Wash the nozzle.

Immerse the nozzle under warm water. Insert the washing syringe for cleaning into a hole on the back of the nozzle. Press the washing syringe to clean the inside of the hole. Clean the other hole in the same manner.

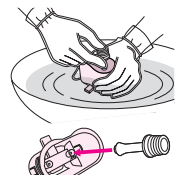

★ Always immerse the nozzle under water for cleaning because the cream may splash.

3 Dry the nozzle

★ Allow nozzle to dry by placing it on a newspaper or piece of paper to prevent staining.

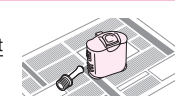

4 Reattach nozzle to bottle once completely dry.

- Attach the nozzle to the bottle until the locks on both sides are fixed tightly.
- Cream 1 and Cream 2 may not come out evenly if the nozzle is not attached firmly to the bottle.
- Take care not to press the push lever while attaching the nozzle to the bottle.

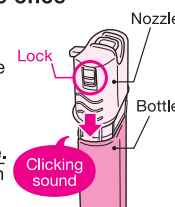

5 Store the product.

- Replace the protection cap and store the product in a cool place.
- Wash the comb-brush, washing syringe and gloves before storing them.

- ★ The following situations may cause staining of clothes, hats and pillowcases.
 - When colored hair is wet (due to heavy perspiration, rain, swimming and hair wash)
 - When hair care products (hair grower, hair liquid and hair foam) are heavily applied
- ★ Repeated partial coloring may cause an uneven result. Therefore, users are advised to color the whole hair once every three months.
- ★ Empty the bottle before discarding. The nozzle and cap are made of plastic, while aluminum is used for the bottle.